

# led driver and led strip of cabinet removal instruction

TURN OFF ELECTRCITY SUPPLY BEFORE WORK IS CARRIED OUT

## 1.LED driver removal step:

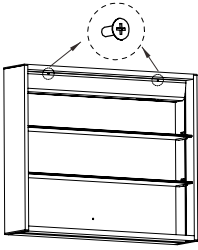

1.Firstly unscrew the electrical box of the cabinet

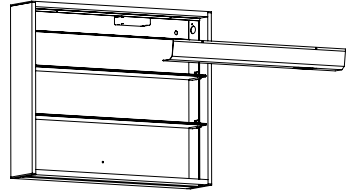

2.Remove the cover of the electrical box

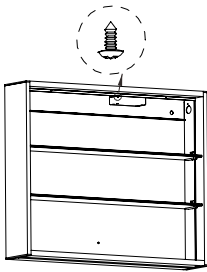

3.unscrew the led driver

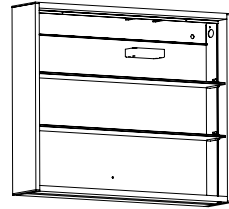

4.Remove the led driver and replace it

## 2.LED strip removal step:

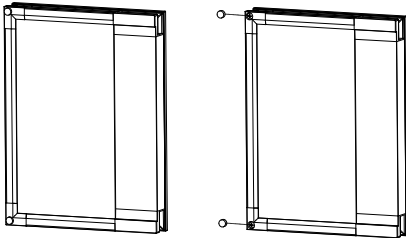

1.Remove the door of cabinet, then remove the silicone pad of inside mirror

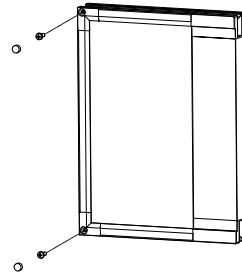

2.Remove the corner connecting parts' screw

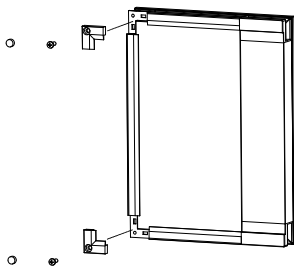

3.Remove corner connecting parts

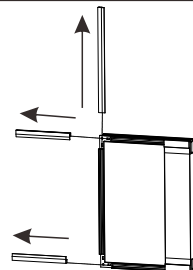

4.Take out the aluminum covers (note the direction)

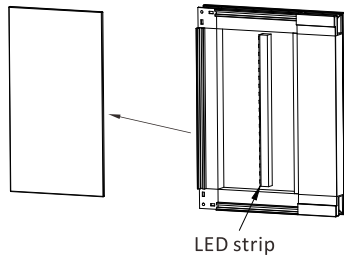

5.Remove the inside mirror and replace the light strip